



# MARCH PUMPS

1819 PICKWICK AVE., GLENVIEW, IL 60026-1306, U.S.A  
 PHONE: (847) 729-5300 - FAX: (847) 729-7062  
 WWW.MARCHPUMP.COM

**DESCRIPTION & OPERATION:** Series 893 are centrifugal magnetic drive pumps. The 893-13 and 893-14 pumps are hermetically encapsulated which allows the pump to be run fully submerged, and the pumps can only be used submerged in the liquid. A flooded suction is essential for operation since the pump is not self-priming. Pumps cannot be run dry because the impeller requires the liquid being pumped for lubrication. For application assistance, contact March Pump.

**ELECTRICAL:** The Brushless Motors have voltage protection. Red lead is positive, black lead is negative.

Model 893-13 (12 VDC) starts at 5.5 V  $\pm$  0.5 V and turns off at 17.5 V  $\pm$  0.5 V.

Model 893-14 (24 VDC) starts at 8.5 V  $\pm$  0.5 V and turns off at 28 V  $\pm$  0.5 V.

## 893 Brushless Paragon Motor w/Voltage Protection 893-13 & 893-14

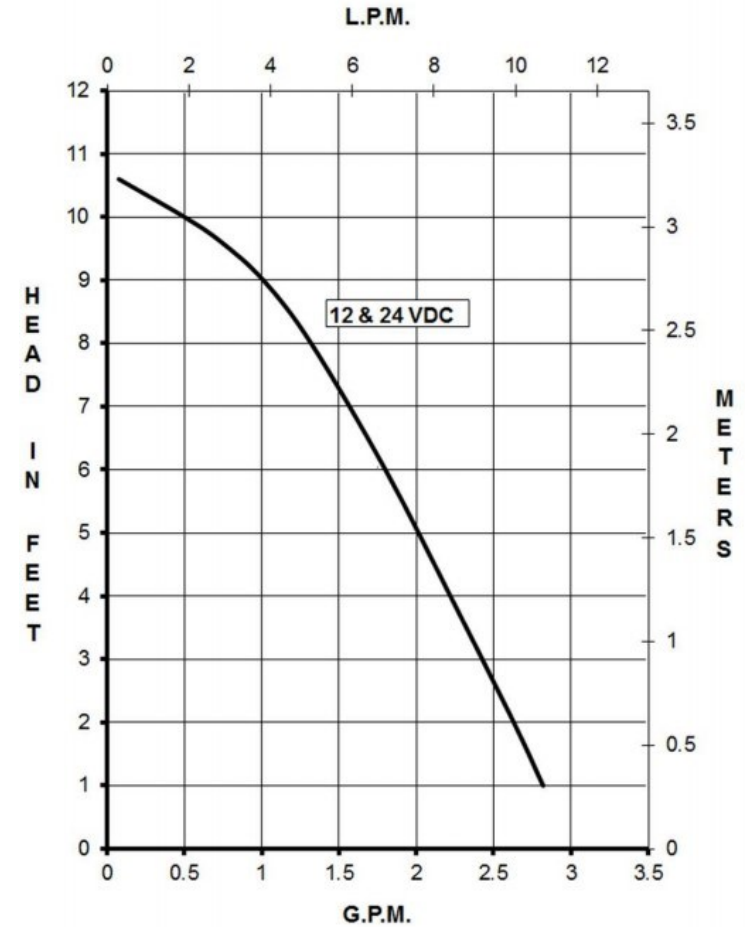

Specifications		893-13 (12V DC)	893-14 (24V DC)
Product	P/N	0893-0072-0100	0893-0073-0100
Inlet-Outlet		3/8" FPT-3/8" OD	3/8" FPT-3/8" OD
Max Internal Pressure		50PSI (344 kPa)	50PSI (344 kPa)
Max Liquid Temperature	Submerged	120F (49C)	120F (49C)

Model	Max Flow		Max Head			Electrical					Packed Weight
	GPM	LPM	FT	PSI	M	Voltage	Amps	HP	kW	RPM	Pounds
893-13	2.7	11	10.6	4.5	3.3	12	0.85	1/150	0.004	4000	1.5
893-14	2.7	11	10.6	4.5	3.3	24	0.5	1/150	0.004	4000	1.5

All specifications & data are based on pumping water & are intended as a guideline only. Specifications may vary with different motors.

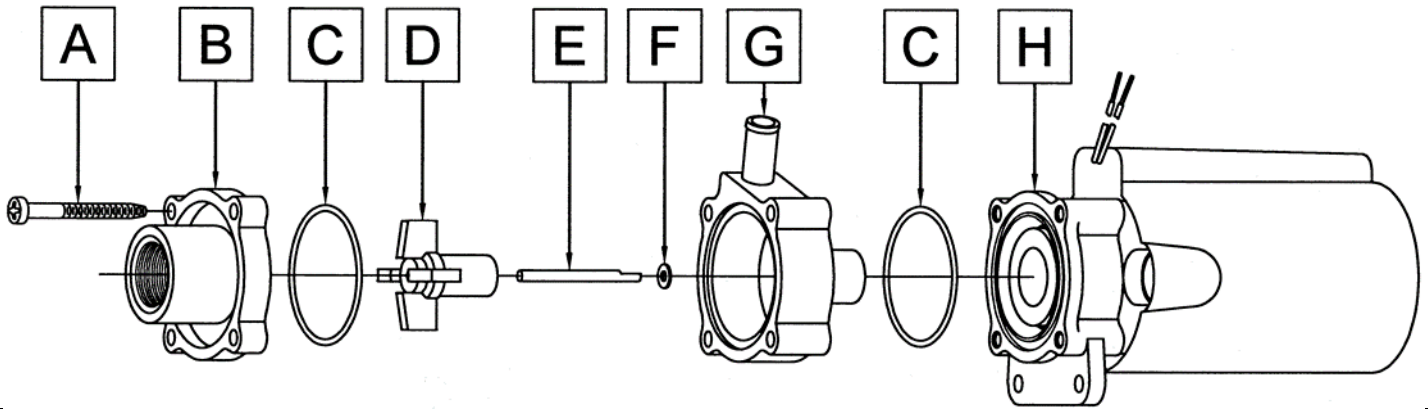

**NOTE**

893-13 (12V DC)				893-14 (24V DC)			
Item	Part Number	QTY REQ	Description	Item	Part Number	QTY REQ	Description
A	0115-0062-1000	4	#7-19 x 1-7/16" Long Self-Tapping Screw (Stainless)	A	0115-0062-1000	4	#7-19 x 1-7/16" Long Self-Tapping Screw (Stainless)
B	0893-0004-1000	1	3/8" FPT Inlet Cover (Noryl)	B	0893-0004-1000	1	3/8" FPT Inlet Cover (Noryl)
C	0115-0018-1000	1	1/16" CS x 1-7/16" OD "O" Ring (Buna N)	C	0115-0018-1000	1	1/16" CS x 1-7/16" OD "O" Ring (Buna N)
D	0115-0119-1000	1	Encapsulated Impeller (Polypropylene)	D	0115-0119-1000	1	Encapsulated Impeller (Polypropylene)
E	0115-0032-1000	1	Shaft (316 Stainless)	E	0115-0032-1000	1	Shaft (316 Stainless)
F	0115-0033-1000	1	Rear Thrust Washer (Carbon/Teflon)	F	0115-0033-1000	1	Rear Thrust Washer (Carbon/Teflon)
G	0893-0003-1000	1	3/8" OD Outlet Rear Housing (Noryl)	G	0893-0003-1000	1	3/8" OD Outlet Rear Housing (Noryl)
H	0893-0074-0100	1	Epoxy Sub Assembly 12V DC	H	0893-0075-0100	1	Epoxy Sub Assembly 24V DC
NOTE: Contact Factory for other materials and/or parts not listed. Special voltage motors are available upon special order.							
<b>Materials in contact with the liquid:</b> Noryl, Polypropylene, Carbon/Teflon, Buna N, 316 Stainless Steel, Epoxy, Delrin, Motor Leads							
<b>LIMITED WARRANTY:</b> March pumps are guaranteed only against defects in workmanship or materials for a period of one year from date of manufacture pumping water. For the complete warranty and to register online go to <a href="http://www.marchpump.com/warranty-registration">www.marchpump.com/warranty-registration</a>							